



Plainfield Public Library
EXPANSION CONCEPTS
July 20, 2016

nagle
hartray
| architecture

**50K SF
EXPANSION
CONCEPTS
ONE VS. TWO STORY**

A 1-story addition provides the Library a large, open floor plate that is more flexible and adaptable than a 2-story addition.

A 2-story addition has a smaller 'footprint' that permits more parking than a 1-story addition.

Originally presented at June Board meeting.

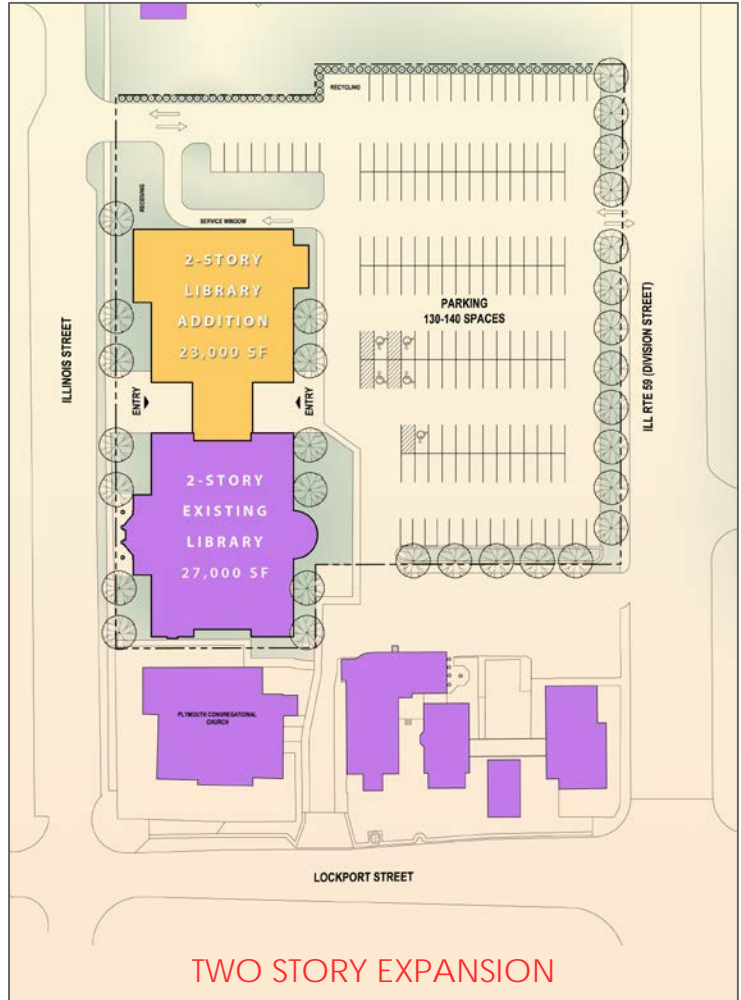
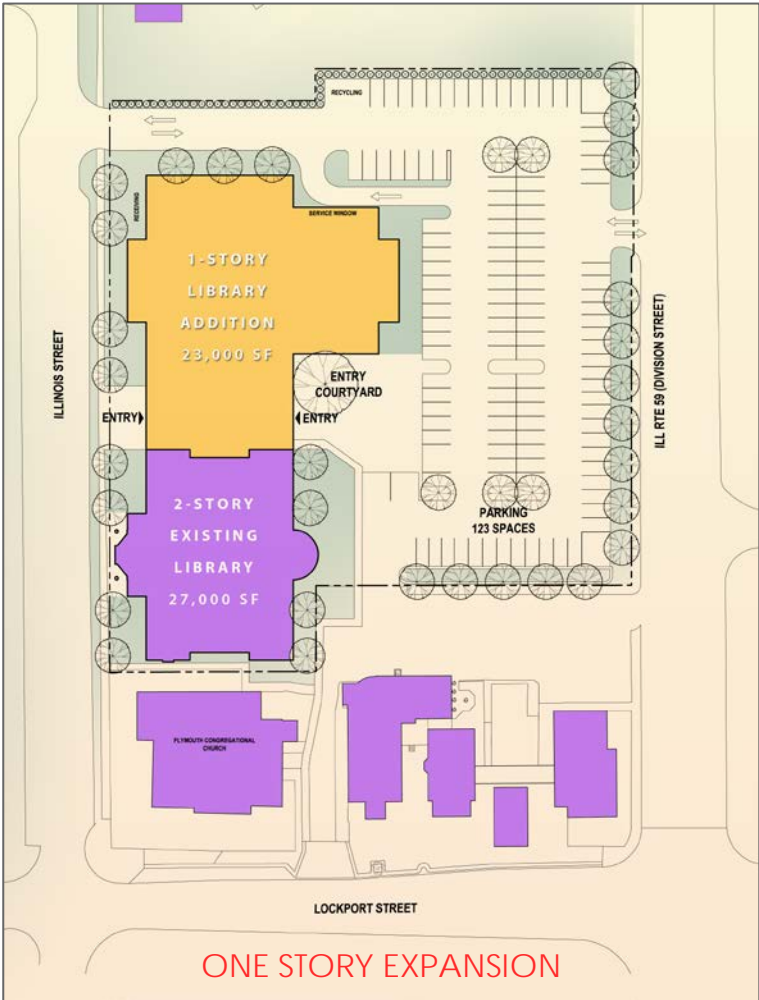

**TWO STORY
EXPANSION
CONCEPT
LOWER LEVEL
PLANS**

The lower level of the existing library building includes meeting rooms and staff areas, the same as in the one story concept.

The expansion lower level, which is at grade, includes the new library entry, popular library services and the young adult area.

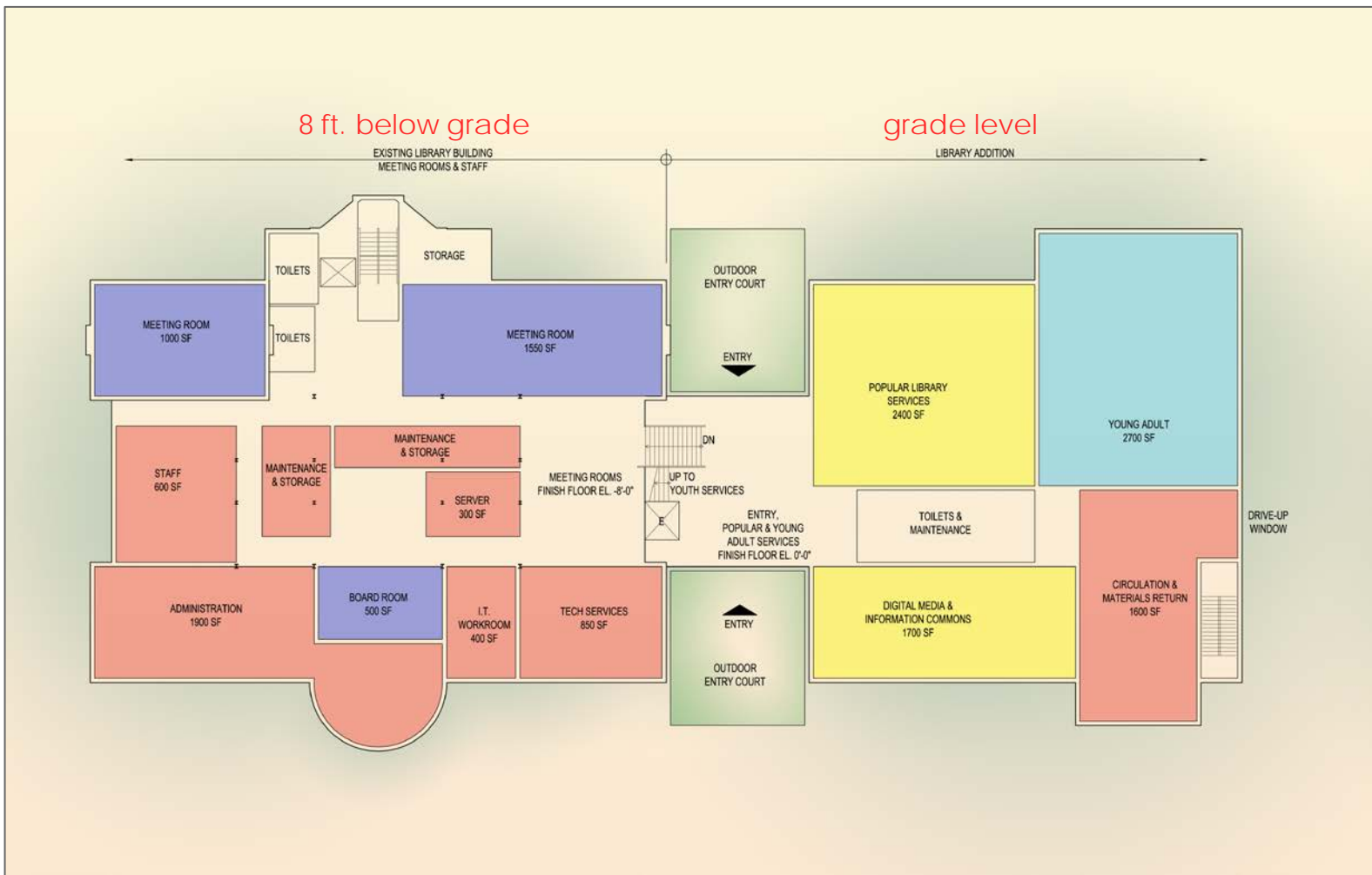

Originally presented at June Board meeting.

TWO STORY EXPANSION CONCEPT UPPER LEVEL PLANS

The upper level of the existing library building consists of youth services, the same as in the one story concept.

The expansion upper level, which would be the highest level in the library, consists of adult services.

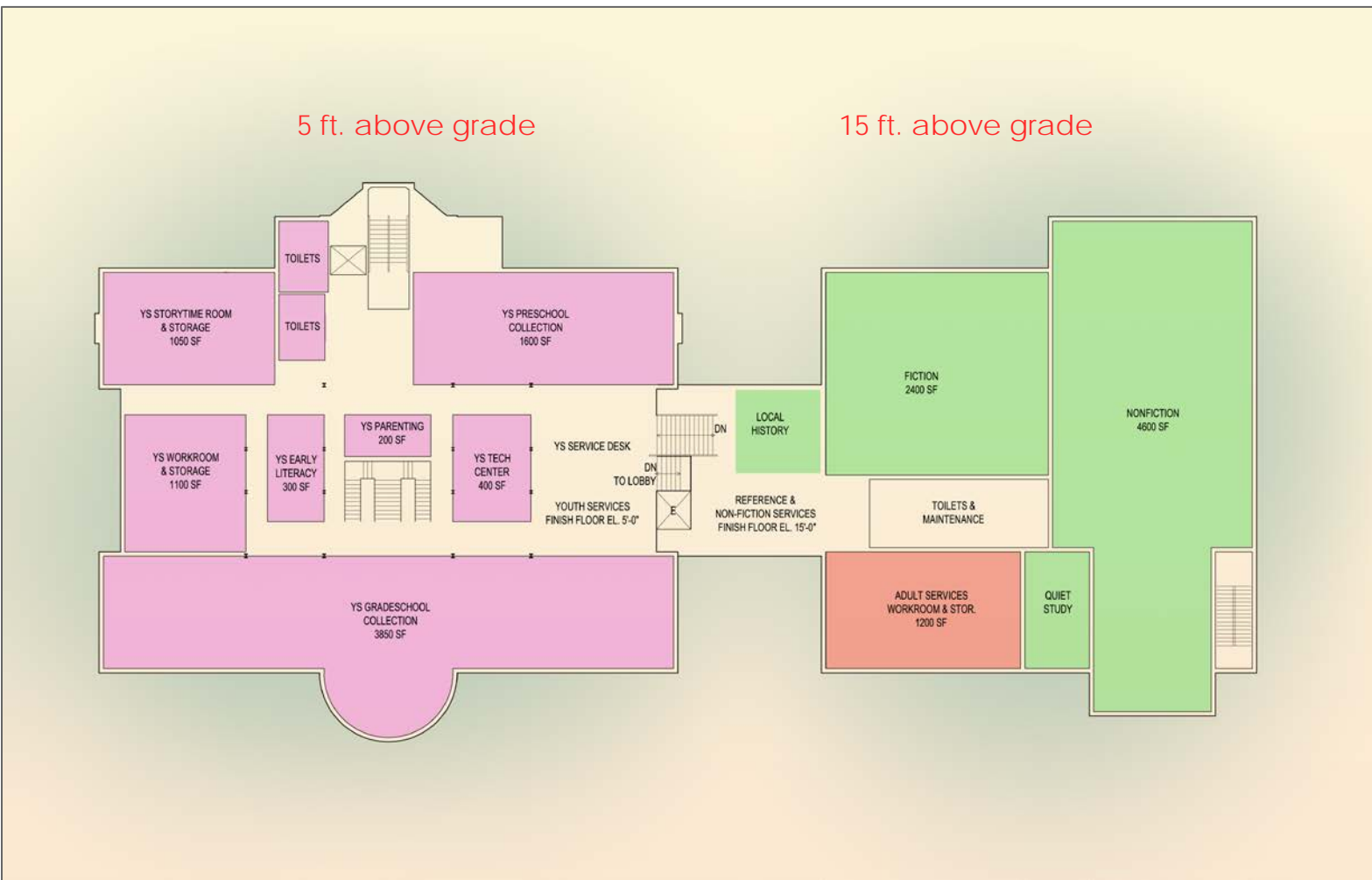

Originally presented at June Board meeting.

**ONE STORY
EXPANSION
CONCEPT
PARKING
CONFIGURATION
OPTIONS**

Of two possible parking orientations, the preferred configuration provides more parking spaces and allows for development of an entry courtyard on the parking lot side.

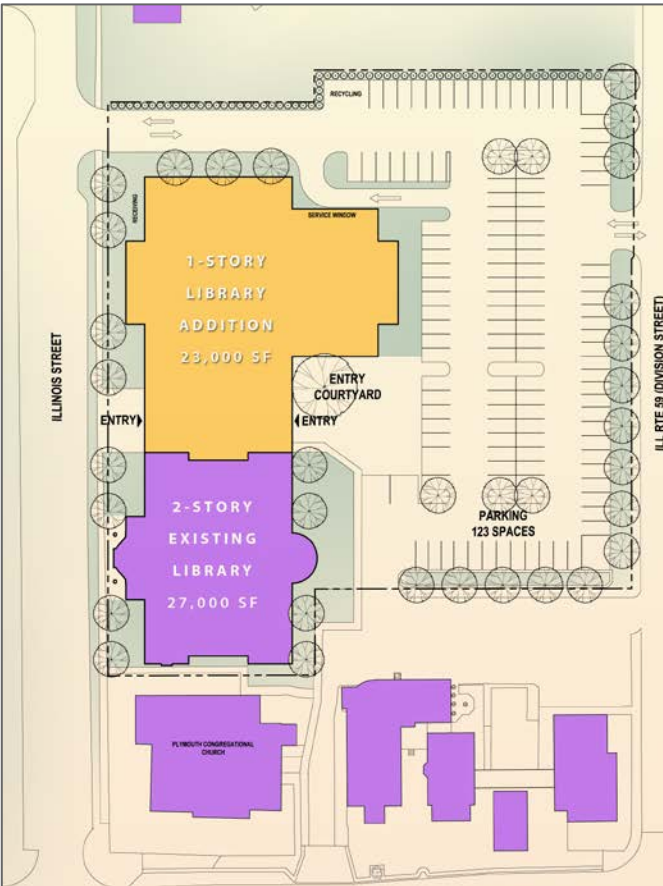

PREFERRED PARKING CONFIGURATION



ALTERNATE PARKING CONFIGURATION

Originally presented at June Board meeting.

**ONE STORY
EXPANSION
CONCEPTS
LOWER LEVEL PLAN**

There is a lower level in the existing portion of the library only in the 1-story expansion option. It includes public meeting rooms and staff and administration areas.

Originally presented at June Board meeting.

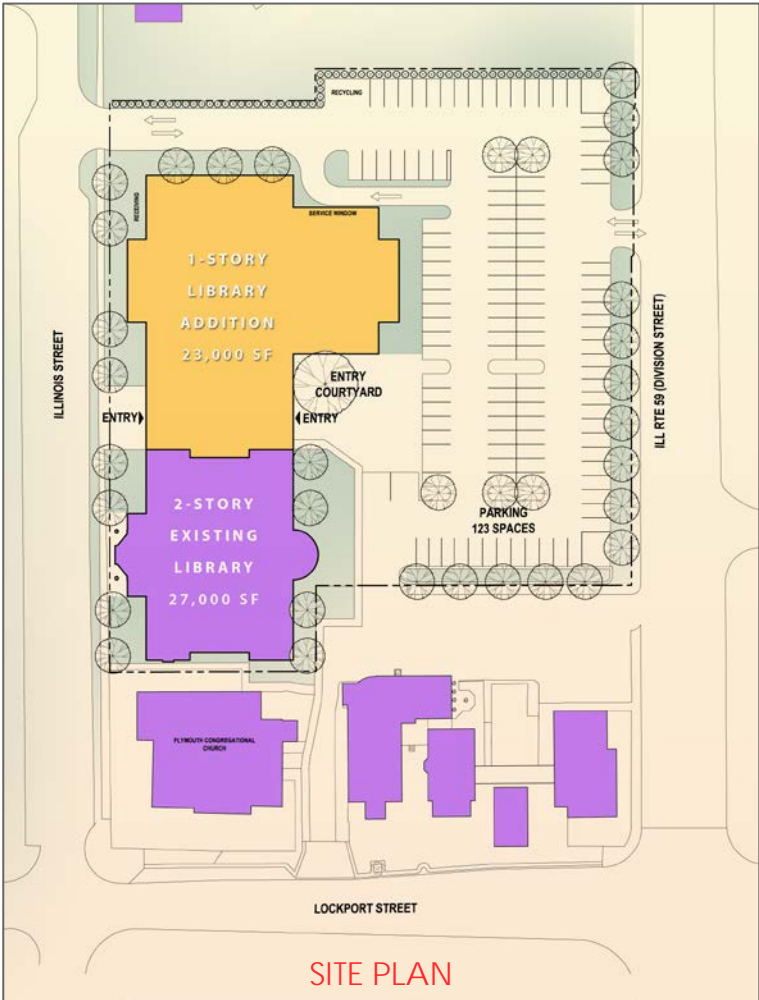

SITE PLAN

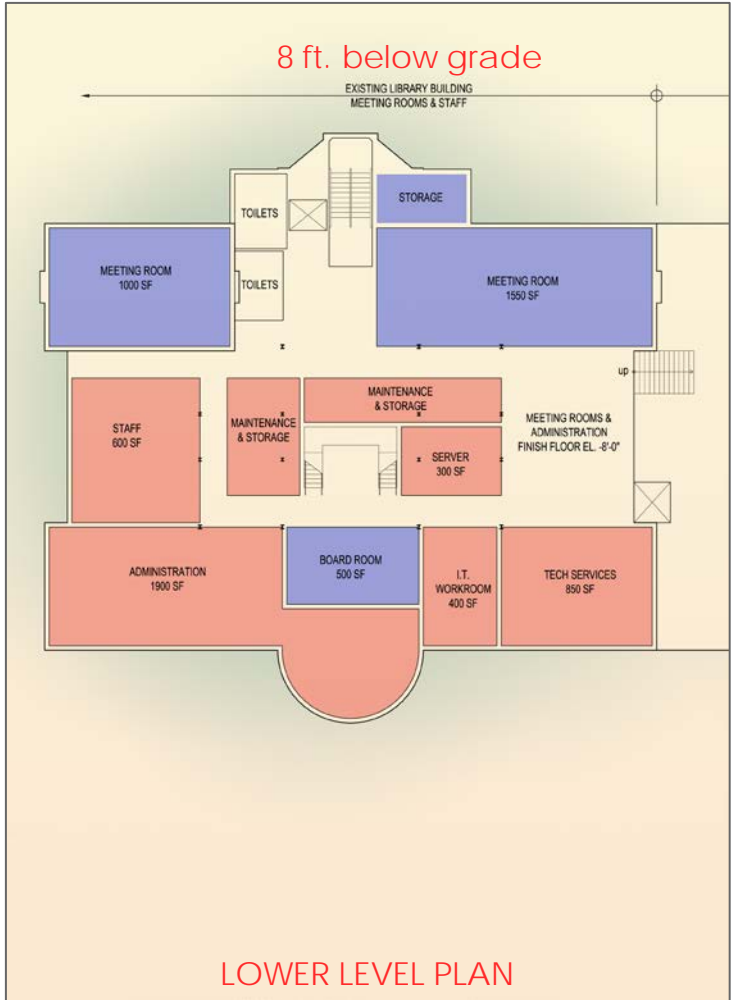

LOWER LEVEL PLAN

**ONE STORY
EXPANSION
CONCEPT
UPPER LEVEL PLAN**

Youth services is located on the upper level of the existing library building.

The one story expansion includes the new building entry, popular library services, adult services and the young adult area.

Originally presented at June Board meeting.

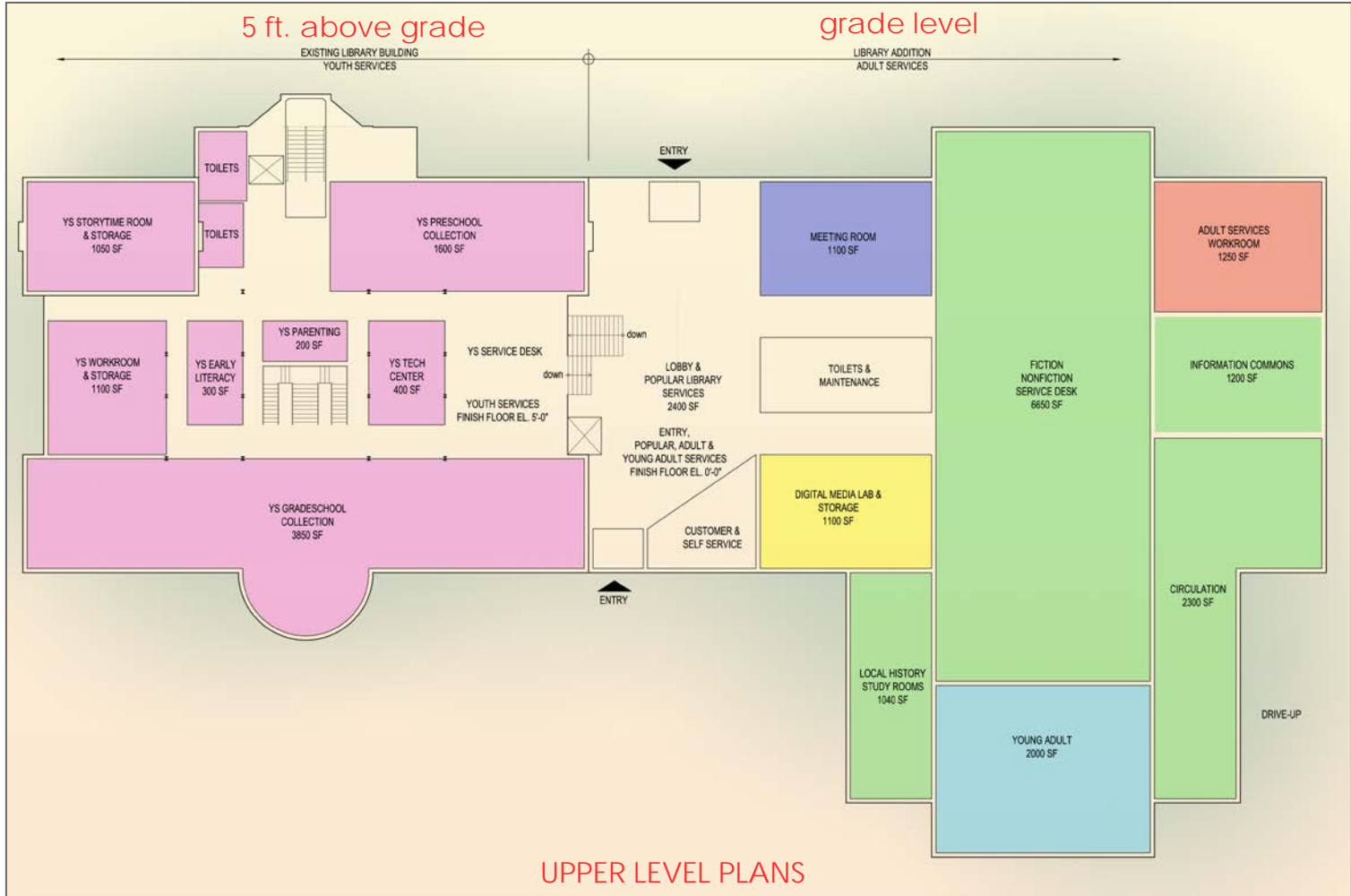

UPPER LEVEL PLANS

**ONE STORY
EXPANSION
CONCEPT
SITE & LOWER LEVEL
PLANS**

Building area is increased by about 5,000 SF to align with latest LPA program, which results in about five fewer parking spaces.

Administration and public meeting rooms remain in the lower level of the existing building.

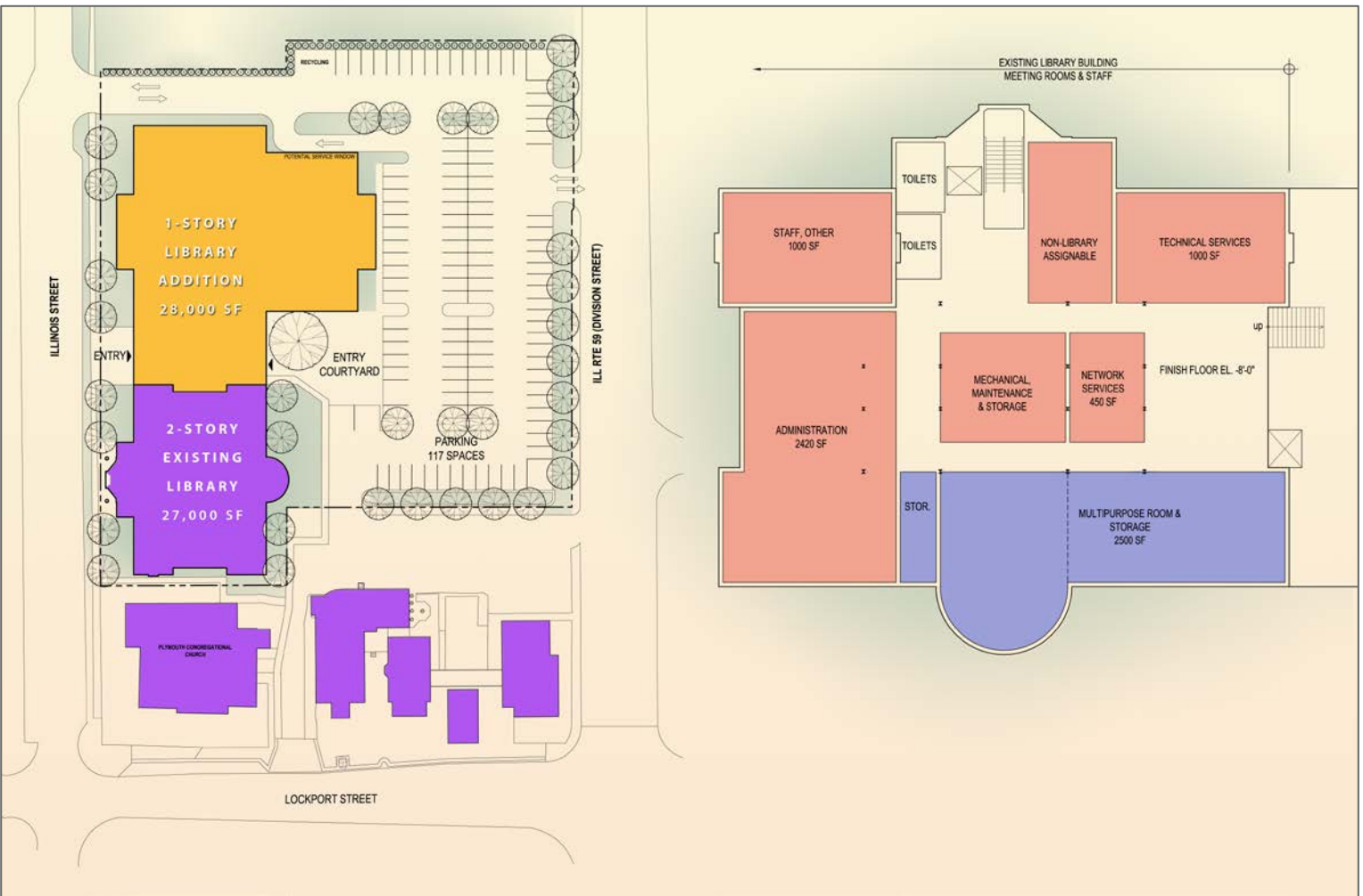

**ONE STORY
EXPANSION
CONCEPT
UPPER LEVEL PLAN**

Youth Services has been relocated to the ground floor for easy access.

Young Adult is located adjacent Youth Services.

Adult Services is located on the upper floor of the existing building.

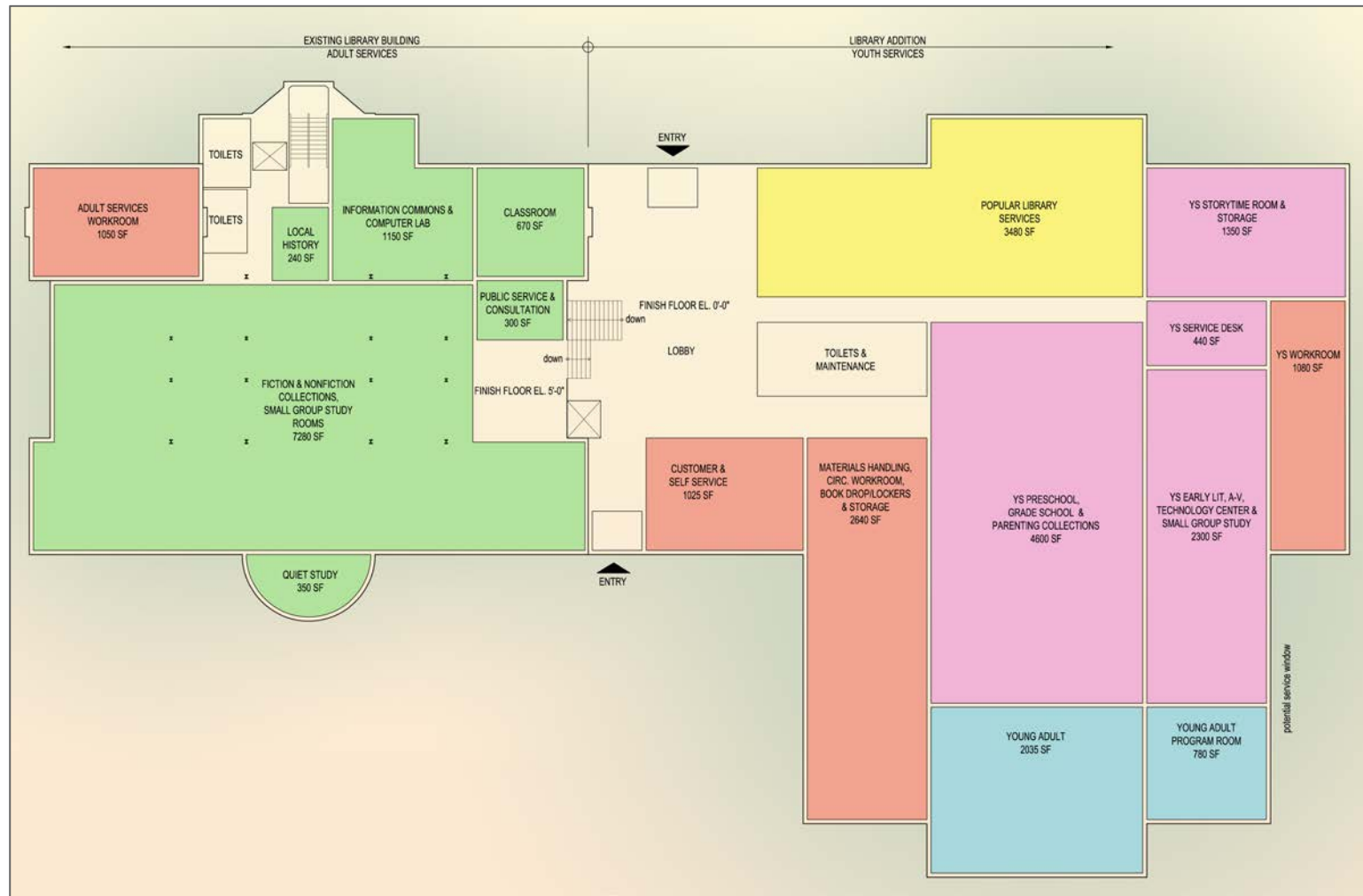

POTENTIAL IMPROVEMENTS COMPARED TO REFERENDUM DESIGN & APPROACH

Building area reduced by more than 20 percent.

Capital cost reduced by more than 25 percent.

More pragmatic and cost effective approach by reusing existing library building.

Same number of service points as existing library, so operational cost referendum unnecessary.

